

Part	L (μ H)	Tol %	R _{DC} MAX (Ω)	I _{bc} (A)
DS5022T-100	10 @100 kHz	M	0.04	8
DS5022T-150	15 @100 kHz	M	0.05	7
DS5022T-220	22 @100 kHz	M	0.06	6
DS5022T-330	33 @100 kHz	M	0.08	5
DS5022T-470	47 @100 kHz	M	0.1	4
DS5022T-680	68 @100 kHz	M	0.14	3
DS5022T-101	100 @100 kHz	M	0.21	2.4
DS5022T-151	150 @100 kHz	M	0.29	2.1
DS5022T-221	220 @100 kHz	M	0.47	1.9
DS5022T-331	330 @100 kHz	M	0.78	1.1
DS5022T-471	470 @100 kHz	M	1.08	1.1
DS5022T-681	680 @100 kHz	M	1.4	0.96
DS5022T-102	1000 @100 kHz	M	2.01	0.8

SPECIFICATION

TYPE = DS5022
 CONSTRUCTION = SURFACE MOUNT POWER INDUCTOR
 TERMINAL COATING = NICKEL ALLOY OVER PHOS BRONZE
 OPERATING TEMP. = -40 TO +85 °C
 STORAGE TEMP = -55 TO +125 °C
 INSULATION RESISTANCE = 100M Ω m. 100V TERMINAL-CORE
 DIELECTRIC STRENGTH = 250Vac TERMINAL-CORE
 HUMIDITY EFFECTS = L \pm 5 @ 95%RH, 40 °C, 1HR
 = Q \pm 5 @ 95%RH, 40 °C, 1HR
 PACKAGING = 1000PCS/REEL
 MARKING = 3 CHARACTERS, VALUE

NOTE

TOLERANCE M=20%.

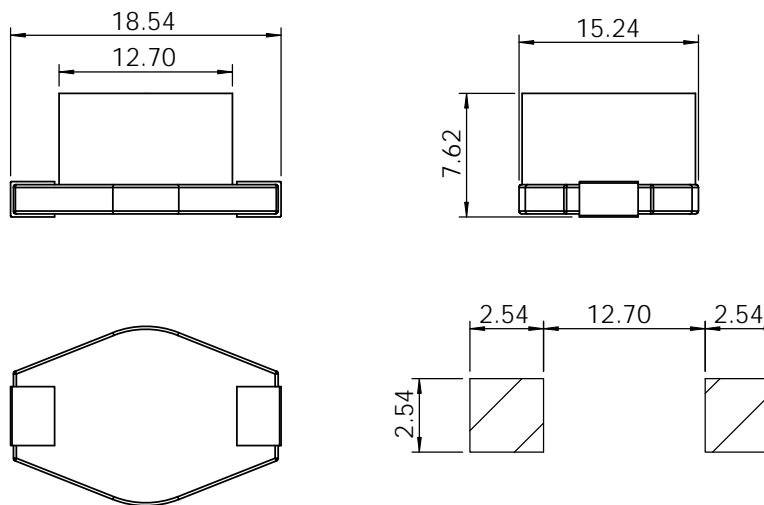

PROPRIETARY AND CONFIDENTIAL THE INFORMATION CONTAINED IN THIS DRAWING IS THE SOLE PROPERTY OF AIT COMPONENTS LTD. ANY REPRODUCTION IN PART OR AS A WHOLE WITHOUT THE WRITTEN PERMISSION OF AIT COMPONENTS LTD IS STRICTLY PROHIBITED.		NAME	DATE	AIT COMPONENTS LTD www.aitcomponents.com
	DRAWN			
	CHECKED			TITLE:
	ENG APPR.			DS5022 SMD POWER INDUCTOR
MATERIAL	--	UNLESS OTHERWISE SPECIFIED DIMENSIONS ARE IN MILLIMETERS TOLERANCES: ONE PLACE DECIMAL +/-0.3 TWO PLACE DECIMAL +/-0.13 ANGLE +/-1 DEGREE		SIZE A DWG. NO. DS5022 SMD POWER INDUCTOR REV. 00
FINISH	--	DO NOT SCALE DRAWING		SCALE:1:1 SHEET 1 OF 1