

Part	L ( $\mu$ H)	Tol %	R <sub>DC</sub> MAX ( $\Omega$ )	I <sub>DC</sub> I <sub>N</sub> (A)
CDRH5D28-2R6	2.6uH @ 10kHz	N	0.018	2.6
CDRH5D28-3R0	3.0uH @ 10kHz	N	0.024	2.4
CDRH5D28-4R2	4.2uH @ 10kHz	N	0.031	2.2
CDRH5D28-5R3	5.3uH @ 10kHz	N	0.038	1.9
CDRH5D28-6R2	6.2uH @ 10kHz	N	0.045	1.8
CDRH5D28-8R2	8.2uH @ 10kHz	N	0.053	1.6
CDRH5D28-100	10uH @ 10kHz	N	0.065	1.3
CDRH5D28-120	12uH @ 10kHz	N	0.076	1.2
CDRH5D28-150	15uH @ 10kHz	N	0.103	1.1
CDRH5D28-180	18uH @ 10kHz	N	0.11	1
CDRH5D28-220	22uH @ 10kHz	N	0.122	0.9
CDRH5D28-270	27uH @ 10kHz	N	0.175	0.85
CDRH5D28-330	33uH @ 10kHz	N	0.189	0.75
CDRH5D28-390	39uH @ 10kHz	N	0.212	0.7
CDRH5D28-470	47uH @ 10kHz	N	0.26	0.62
CDRH5D28-560	56uH @ 10kHz	N	0.305	0.58
CDRH5D28-680	68uH @ 10kHz	N	0.355	0.52
CDRH5D28-820	82uH @ 10kHz	N	0.463	0.46
CDRH5D28-101	100uH @ 10kHz	N	0.52	0.42

**SPECIFICATION**

TYPE = CDRH5D28  
CONSTRUCTION = SURFACE MOUNT POWER INDUCTOR  
TERMINAL COATING = NICKEL / SILVER  
OPERATING TEMP. = -40 TO +85 °C  
STORAGE TEMP = -55 TO +125 °C  
INSULATION RESISTANCE = 100MOhm. 100V TERMINAL-CORE  
DIELECTRIC STRENGTH = 250Vac TERMINAL-CORE  
HUMIDITY EFFECTS = L±5 @ 95%RH, 40 °C, 1HR  
= Q±5 @ 95%RH, 40 °C, 1HR  
PACKAGING = 2000PCS/REEL  
MARKING = 3 CHARACTERS, VALUE

**NOTE**

TOLERANCES L=15%; M=20%; N=30%

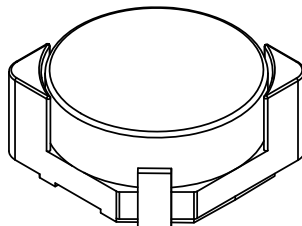
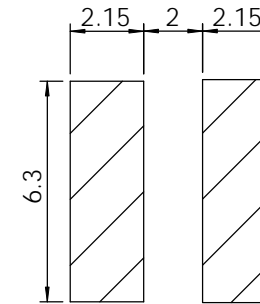
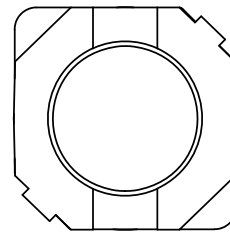
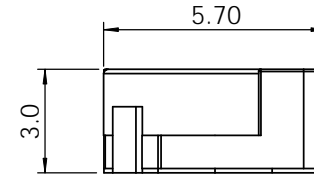
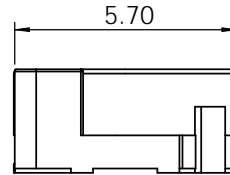

<b>PROPRIETARY AND CONFIDENTIAL</b> THE INFORMATION CONTAINED IN THIS DRAWING IS THE SOLE PROPERTY OF AIT COMPONENTS LTD. ANY REPRODUCTION IN PART OR AS A WHOLE WITHOUT THE WRITTEN PERMISSION OF AIT COMPONENTS LTD IS STRICTLY PROHIBITED.	NAME	DATE	<b>AIT COMPONENTS LTD</b> <a href="http://www.aitcomponents.com">www.aitcomponents.com</a>
	DRAWN		
	CHECKED		
MATERIAL	UNLESS OTHERWISE SPECIFIED DIMENSIONS ARE IN MILLIMETERS TOLERANCES: ONE PLACE DECIMAL +/-0.3 TWO PLACE DECIMAL +/-0.13 ANGLE +/-1 DEGREE		TITLE:  <b>CDRH6D28 SMD POWER INDUCTOR</b>
FINISH	DO NOT SCALE DRAWING		SIZE <b>A</b> DWG. NO. CDRH6D28 SMD POWER INDUCTOR REV. <b>00</b>
SCALE:1:1			SHEET 1 OF 1