



.049" (1.25mm) Center Wafer Assembly

9226 Series (SMT TYPE)

FEATURES:

- . 2-15 Circuits
- . .013" [0.35mm] round wire pins brass
- . Nylon 46, [UL 94V-0]
- . Contact: Phosphor Bronze
- . Mates with 9225 PC Board connectors

SPECIFICATIONS:

- . Current rating: 1A AC, DC
- . Voltage rating: 125V AC, Maximum
- . Temperature range: -40°C ~ +85°C
- . Dielectric Withstanding Voltage: 250V AC/1 min
- . Insulation resistance: 100 MΩ min
- . Applicable PC Board thickness 08 ~ 1.6mm
- . Contact resistance: 20mΩ max

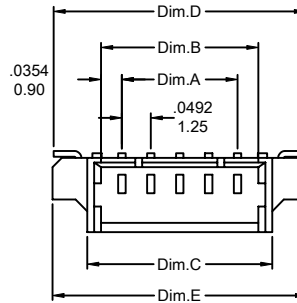

UNIT: INCH
MM

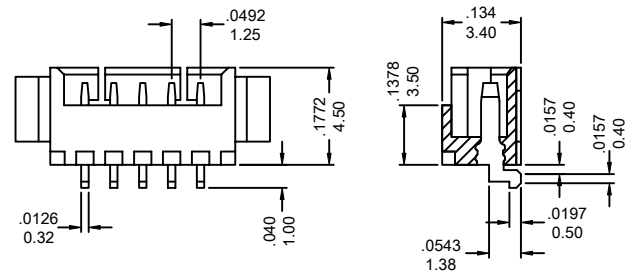
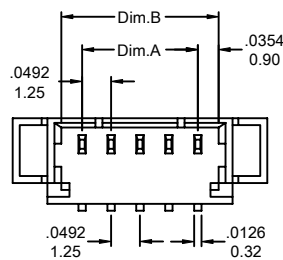

(R: Right Angle)

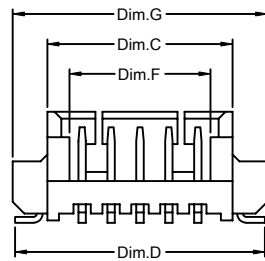

(S: Straight)

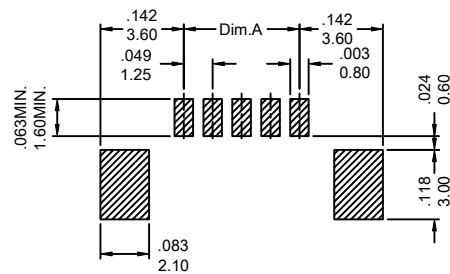
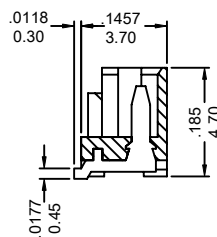

RECOMMENDED P.C.BOARD PATTERN DIM.(REF.)

Ordering Information 9226 Series

Series No.	No. of Contacts	Contact Type	Contacts Plating	PCB Mount	
9226	- 05P	S	T	- SMT	- PB
9226 Series	02P ~ 15P	S: Straight R: Right Angle	T: Tin G: Gold Flash	SMT	RoHs

Dimensional Information

Circuits	Dim.A± .008 0.20	Dim.B± .008 0.20	Dim.C± .008 0.20	Dim.D± .008 0.20	Dim.E± .008 0.20	Dim.F± .008 0.20	Dim.G± .008 0.20	Circuits	Dim.A± .008 0.20	Dim.B± .008 0.20	Dim.C± .008 0.20	Dim.D± .008 0.20	Dim.E± .008 0.20	Dim.F± .008 0.20	Dim.G± .008 0.20
2	.049 1.25	.120 3.05	.167 4.25	.281 7.15	.285 7.25	.093 2.35	.301 7.65	3	.098 2.50	.169 4.30	.217 5.50	.331 8.40	.335 8.50	.142 3.60	.350 8.90
4	.148 3.75	.219 5.55	.266 6.75	.380 9.65	.384 9.75	.191 4.85	.400 10.15	5	.197 5.00	.268 6.80	.315 8.00	.429 10.90	.433 11.00	.240 6.10	.449 11.40
6	.246 6.25	.317 8.05	.364 9.25	.478 12.15	.482 12.25	.289 7.35	.498 12.65	7	.295 7.50	.366 9.30	.413 10.50	.528 13.40	.531 13.50	.339 8.60	.547 13.90
8	.344 8.75	.415 10.55	.463 11.75	.577 14.65	.581 14.75	.388 9.85	.596 15.15	9	.394 10.00	.465 11.80	.512 13.00	.626 15.90	.630 16.00	.437 11.10	.646 16.40
10	.443 11.25	.514 13.05	.561 14.25	.675 17.15	.679 17.25	.486 12.35	.695 17.65	11	.492 12.50	.563 14.30	.610 15.50	.724 18.40	.728 18.50	.535 13.60	.744 18.90
12	.541 13.75	.612 15.55	.659 16.75	.774 19.65	.778 19.75	.595 14.85	.793 20.15	13	.590 15.00	.661 16.80	.709 18.00	.823 20.90	.827 21.00	.634 16.10	.842 21.40
14	.640 16.25	.711 18.05	.758 19.25	.872 22.15	.876 22.25	.683 17.35	.892 22.65	15	.689 17.50	.760 19.30	.807 20.50	.921 23.40	.925 23.50	.732 18.60	.941 23.90