

.098" (2.50mm) Center Wafer Assembly

8600 Series

FEATURES:

- . 2-15 Circuits
- . Nylon 66, [UL 94V-0]
- . .025"[0.64mm] square wire pins
- . Mates with 8000 crimp terminal housing

SPECIFICATIONS:

- . Current rating: 3A AC, DC
- . Voltage rating: 250V AC, Maximum
- . Temperature range: -25°C ~ +85°C
- . Contact resistance: Initial Value/10mΩ max.
After environmental testing
/20mΩ max.
- . Insulation resistance: 1000 MΩ min 500V/DC
- . Withstand Voltage: 800V AC/minute
- . Applicable wires: AWG #22 ~ #30

UNIT: INCH
MM

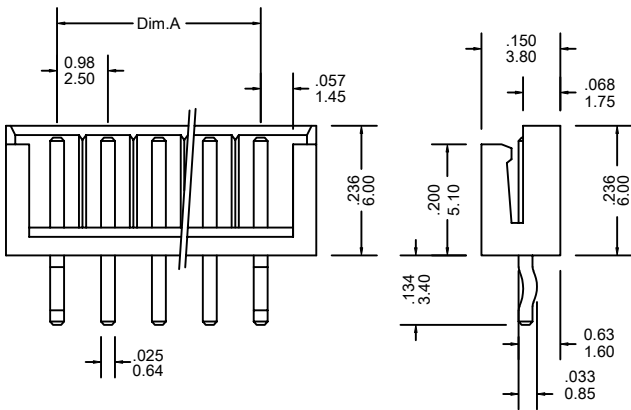
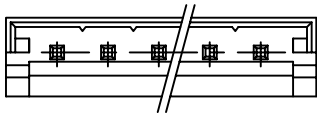

(S: Straight)

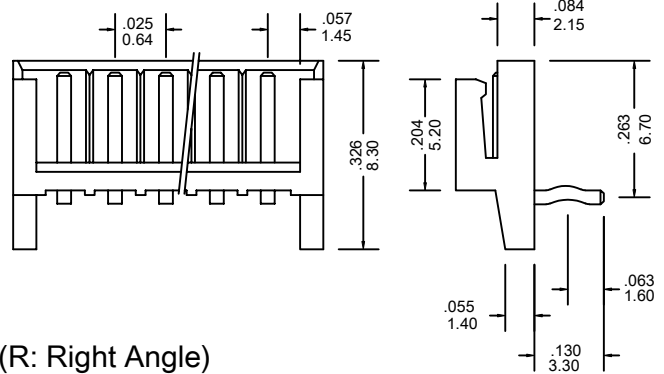
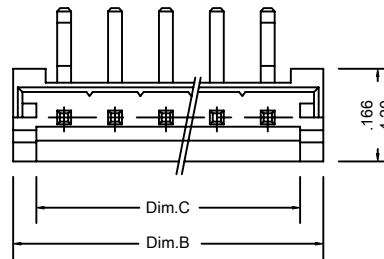

(R: Right Angle)

Ordering Information 8600 Series

Series No.	No. of Contacts	Contact Type	Contact Plating	
8600	- 05P	S	G1	- PB
8600 Series	02P ~ 15P	S: Straight R: Right Angle	T: Tin G1: Gold Flash G5: 5u" Gold G10: 10u" Gold G15: 15u" Gold G30: 30u" Gold [G: Full Gold]	RoHs

Dimensional Information

Circuits	Dim.A± .008 0.20	Dim.B± .012 0.30	Dim.C± .012 0.30	Circuits	Dim.A± .008 0.20	Dim.B± .012 0.30	Dim.C± .012 0.30
2	.098 2.50	.295 7.50	.212 5.40	3	.197 5.00	.393 10.0	.311 7.90
8600 Series * FOR CIRCUIT SIZES 4 THROUGH 15 ADD .098" OR 2.50MM FOR EACH ADDITIONAL PIN.							