

.098" (2.50mm) Center Wafer Assembly

7600 Series

FEATURES:

- . 2-20 Circuits
- . Friction lock
- . Nylon [UL 94V-0]
- . .025"[0.64mm] right angle or straight square wire pins
- . Mates with 7000 crimp terminal housing

SPECIFICATIONS:

- . Current rating: 3A AC, DC
- . Voltage rating: 250V AC, Maximum
- . Temperature range: -40°C ~+ 105°C
- . Contact resistance: Initial Value/10mΩ max.
After environmental testing /20mΩ max.
- . Insulation resistance: 5000 MΩ min
- . Withstand Voltage: 1500V AC/minute
- . Applicable PC board thickness: .063"[1.6mm]

UNIT: INCH
MM

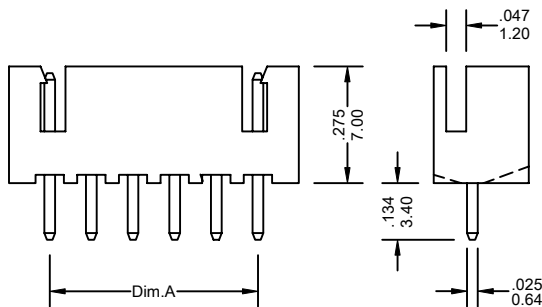
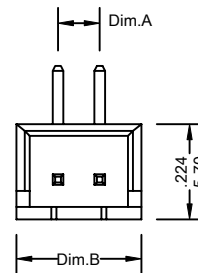
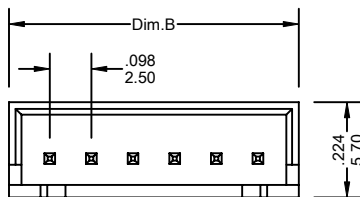

(Straight)

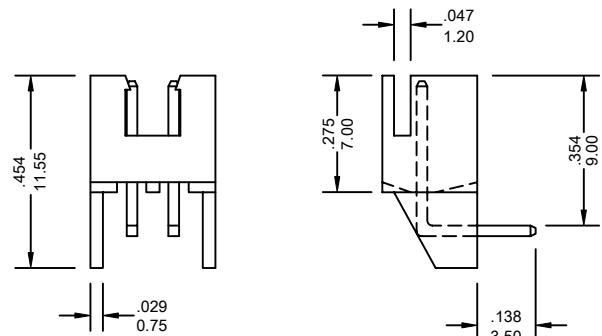

(Right Angle)

Ordering Information 7600 Series

| Series No. | No. of Contacts | Contact Type | Contact Plating | |
|-------------|-----------------|-------------------------------|--|------|
| 7600 | - 06P | S | G1 | - PB |
| 7600 Series | 02P ~ 20P | S: Straight R: Right Angle | T: Tin G1: Gold Flash G5: 5u" Gold G10: 10u" Gold G15: 15u" Gold G30: 30u" Gold [G: Full Gold] | RoHs |

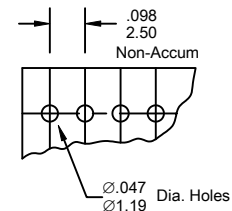

Recommended P.C. Board Hole Dimensions

Dimensional Information

| Circuits | Dim.A± .008 0.20 | Dim.B± .008 0.20 | Circuits | Dim.A± .008 0.20 | Dim.B± .008 0.20 | Circuits | Dim.A± .008 0.20 | Dim.B± .008 0.20 |
|----------|---------------------|---------------------|----------|---------------------|---------------------|----------|---------------------|---------------------|
| 2 | .098 2.50 | .291 7.40 | 3 | .197 5.00 | .390 9.90 | 4 | .295 7.50 | .488 12.40 |

7600 Series

* FOR CIRCUIT SIZES 5 THROUGH 20 ADD .098" OR 2.50MM FOR EACH ADDITIONAL PIN.