

.100" (2.54mm) Center P.C. Board Connectors

2801 Series

FEATURES:

- . 2-40 Circuits
- . PBT + 30% Glass Fiber [UL 94V-0]
- . Designed for parallel and perpendicular board stacking, also for PCB-to-harness and PCB-to-chassis connections
- . Stackable side-to-side on .100"[2.54mm] grid
- . Mates with .025"[0.64mm] square pins mounted on a board right angle headers, and straight headers

SPECIFICATIONS:

- . Current rating: 3A AC. DC
- . Voltage rating: 250V AC. Maximum
- . Temperature range: -40°C ~ +105°C
- . Contact resistance: Initial Value/10mΩ max.
After environmental testing /20mΩ max.
- . Insulation resistance: 1000 MΩ min
- . Withstand voltage: 1500V AC/minute
- . Applicable PC board thickness: .063"[1.6mm]

UNIT: INCH
MM

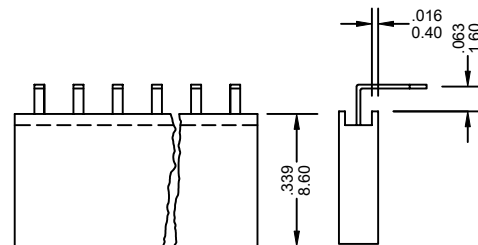
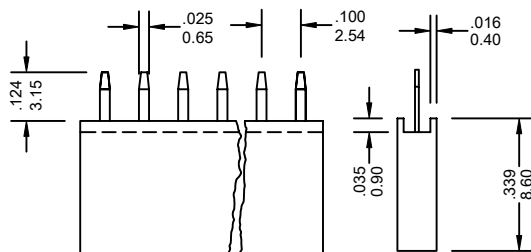
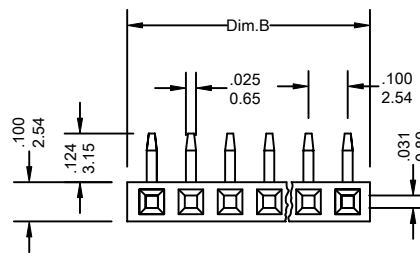
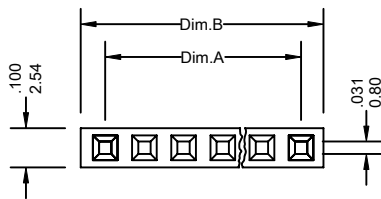

(S: Straight)

(R: Right Angle)

Ordering Information 2801 Series

Series No.	No. of Contacts	Contact Type	Contact Plating	
2801	- 04P	S	G1	- PB
2801 Series	02 ~ 40P	S: Straight R: Right Angle	T: Tin G1: Gold Flash S1: Gold Flash S5: 5u" Gold S10: 10u" Gold S15: 15u" Gold S30: 30u" Gold [G: Full Gold] [S: Selective Gold]	RoHs

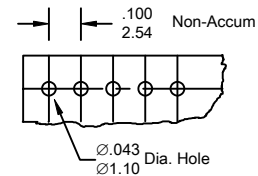

Recommended P.C. Board Hole Layout for .100" [2.54mm] Wafers

Dimensional Information

Circuits	Dim.A± .008 0.20	Dim.B± .008 0.20	Circuits	Dim.A± .008 0.20	Dim.B± .008 0.20	Circuits	Dim.A± .008 0.20	Dim.B± .008 0.20
2	.100 2.54	.220 5.58	3	.200 5.08	.320 8.12	4	.300 7.62	.420 10.66

2801 Series

* FOR CIRCUIT SIZES 5 THROUGH 40 ADD .100" OR 2.54MM FOR EACH ADDITIONAL PIN.