

.079"X.079" (2.00mmX2.00mm) Center Dual Row PCB Wafer



2060 Series

FEATURES:

- . 10-32 Circuits
- . .0197"[0.50mm] Square wire pins
- . NYLON 66, [UL 94V-0]
- . Straight or right angle pins
- . Mates with 2020 housing

SPECIFICATIONS:

- . Current rating: 2A AC, DC
- . Voltage rating: 250V AC, Maximum
- . Temperature range: -40°C ~+ 105°C
- . Contact resistance: Initial Value/10mΩ max.
After environmental testing /20mΩ max.
- . Insulation resistance: 5000 MΩ min
- . Withstand Voltage: 1500V AC/minute
- . Applicable PC Board thickness: .063"[1.6mm]

UNIT: INCH
MM

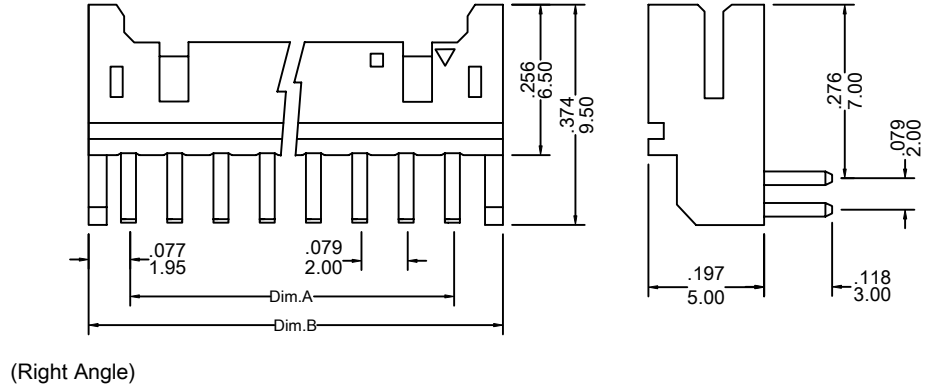
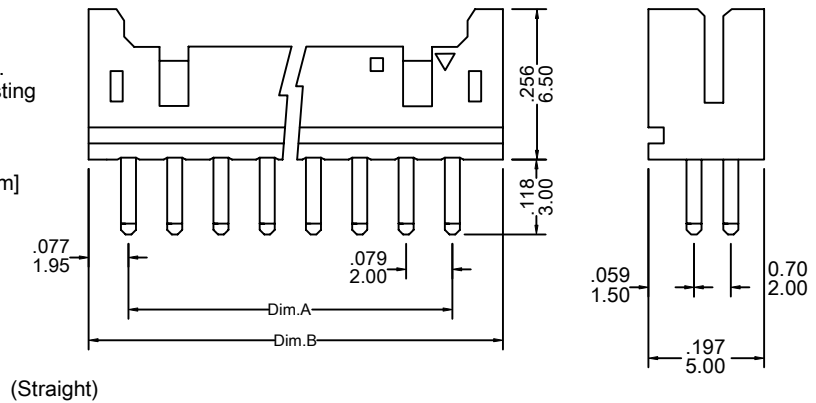

Ordering Information 2060 Series

Series No.	No. of Contacts	Contact Type	Contact Plating	
2060	- 2X05P	S	T	- PB
2060 Series	2X05P ~ 2X16P	S: Straight R: Right Angle	T: Tin	RoHs

Dimensional Information

Circuits	10	12	14	16	18	20	22	24	26	28	30	32	
Dim.A±	.008 0.20	.315 8.00	.400 10.00	.472 12.00	.551 14.00	.630 16.00	.709 18.00	.787 20.00	.866 22.00	.945 24.00	1.020 26.00	1.100 28.00	1.180 30.00
Dim.B±	.008 0.20	.470 11.90	.547 13.90	.626 15.90	.704 17.90	.780 19.90	.862 21.90	.941 23.90	1.020 25.90	1.100 27.90	1.180 29.90	1.260 31.90	1.330 33.90