

.165" (4.20mm) Single Row Housing

15557 Series (Receptacle)

FEATURES:

- . 3-5 Circuits
- . Positive Housing locks
- . Nylon 66 [UL 94V-2] or [UL 94V-0], Nature
- . 10 milliohm contact resistance
- . Low engagement force terminal
- . Fully isolated terminals
- . Accepts double cantilever crimp terminal [15557-TH-T]

SPECIFICATIONS:

- . Current rating: 9A AC, DC Per circuit
- . Voltage rating: 600 (RMS)
- . Temperature range: -40°C ~ +105°C
- . Contact resistance: Initial Value/10mΩ max.
After environmental testing
/20mΩ max.
- . Insulation resistance: 5000 MΩ min
- . Withstand Voltage: 1500V AC/minute
- . Applicable PC board thickness: .070"[1.78mm] max

UNIT: INCH
MM

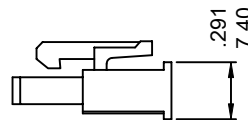
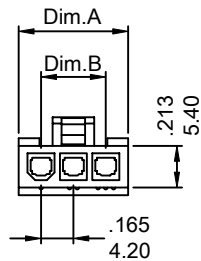
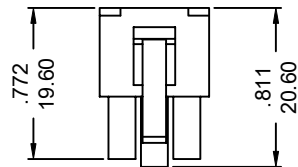

Ordering Information 15557 Series

Series No.	No. of Contacts	Material	
15557	- 1X03P	- V0	- A
15557 Series	1X03P ~ 1X05P	V0: UL 94V-0,Nature V2: UL 94V-2,Nature	RoHs

Dimensional Information

Circuits	Dim.A± .008 0.20	Dim.B± .008 0.20	Circuits	Dim.A± .008 0.20	Dim.B± .008 0.20	Circuits	Dim.A± .008 0.20	Dim.B± .008 0.20
3	.543 13.80	.331 8.40	4	.709 18.00	.496 12.60	5	.874 22.20	.661 16.80