

.049" (1.25mm) Center P.C.Board Connectors

1251 Series

FEATURES:

- . 2-15 Circuits
- . Mates with .013" [0.35mm] Terminals wire pins
- . Nylon 66, [UL 94V-0]
- . Accepts double cantilever crimp terminal [TU1257TPO Series]
- . Mates with 1256 series wafers polarized

SPECIFICATIONS:

- . Current rating: 1A AC, DC
- . Voltage rating: 250V AC, Maximum
- . Temperature range: -25°C ~ +85°C
- . Insulation resistance: 1000 MΩ min
- . Withstand Voltage: 500V AC/minute
- . Applicable wires: AWG #28 ~ #32

UNIT: INCH
MM

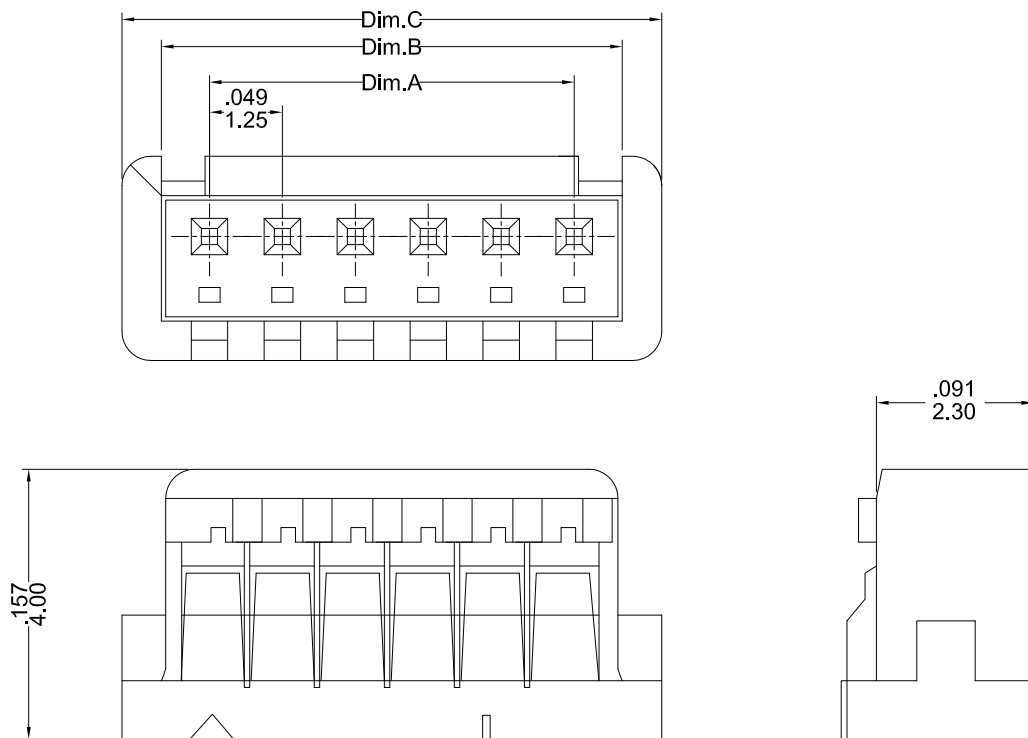

Ordering Information 1251 Series

Series No.	No. of Contacts	
1251	- 1X06P - A	
1251 Series	1X02P ~ 1X15P	RoHs

Dimensional Information

Circuits	Dim.A± .008 0.20	Dim.B± .008 0.20	Dim.C± .008 0.20	Circuits	Dim.A± .008 0.20	Dim.B± .008 0.20	Dim.C± .008 0.20
2	.049 1.25	.120 3.05	.163 4.15	3	.098 2.50	.169 4.30	.212 5.40
4	.147 3.75	.218 5.55	.261 6.65	5	.196 5.00	.267 6.80	.311 7.90
6	.246 6.25	.316 8.05	.360 9.15	7	.295 7.50	.366 9.30	.409 10.40
8	.344 8.75	.415 10.55	.458 11.65	9	.393 10.00	.464 11.80	.507 12.90

1251 Series

* FOR CIRCUIT SIZES 10 THROUGH 15 ADD .049" OR 1.25MM FOR EACH ADDITIONAL PIN.